



# Johnson<sup>®</sup>

## OUTBOARDS

# Service Manual

150, 175 FFI<sup>™</sup>

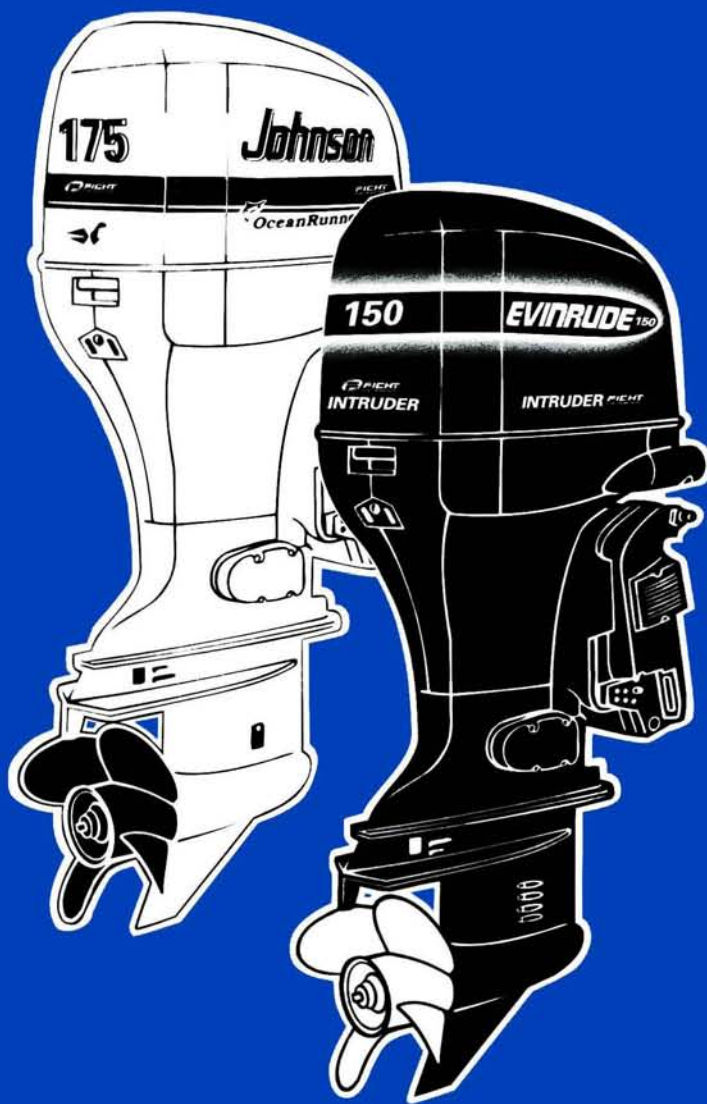

# EVINRUDE<sup>®</sup>

## OUTBOARDS

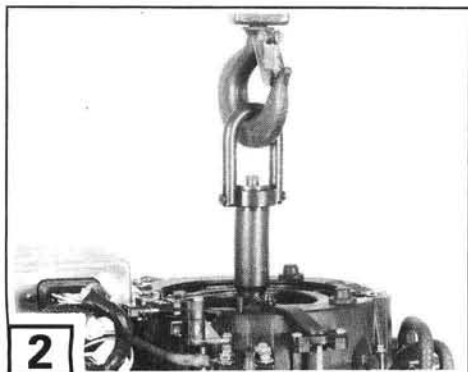

46283

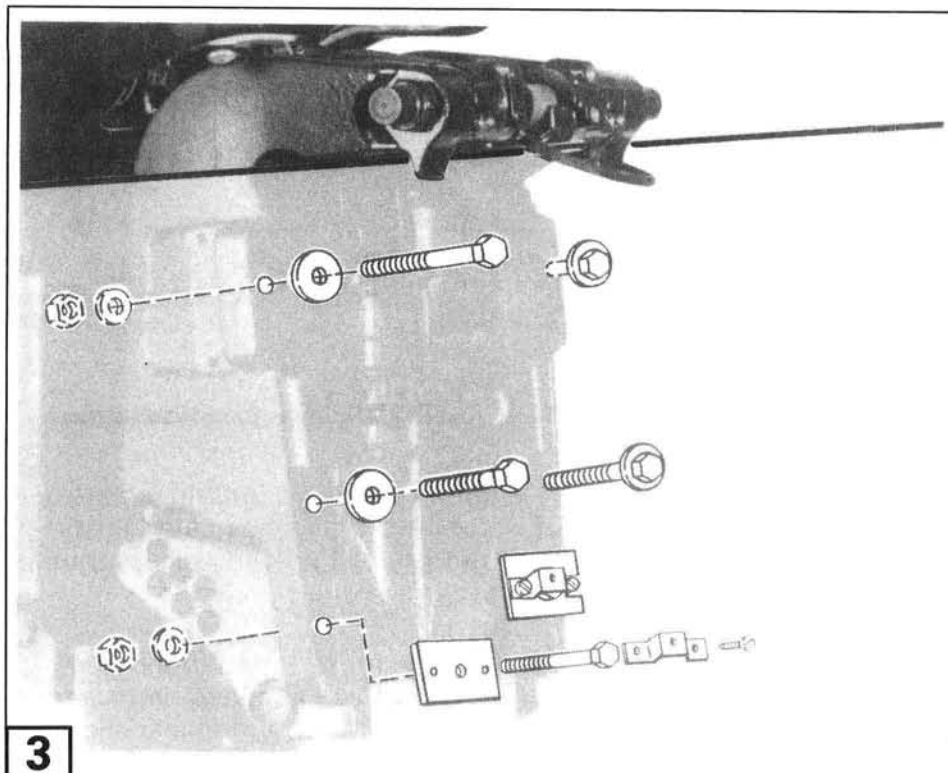

DR5536

## Lifting Information

Release all four flywheel cover mounting cords. Lift flywheel cover off engine and lay aside.

**2** ⚠️ Install **OMC** Lifting Tool, P/N 342672, on crankshaft. **Tighten mounting screw securely using an Allen 1/4 in. hexagonal wrench.**

**4** **Note** Do not allow the hoist lifting hook or chain to make contact with any part of the engine during lifting.

## Secure Outboard to Transom

⚠️ Grease and install steering cable in tilt pivot tube. **Tighten anchor nut to steering manufacturer's recommended torque.**

**3** Use the mounting hardware that attached outboard to shipping carton to secure outboard to transom. For procedures, refer to Installation Guidelines, P/N 507226. Tighten mounting bolt locknuts in the following sequence:

- 10 ft. lbs.
- 25 ft. lbs.
- 40 ft. lbs.

Remove **OMC** Lifting Tool from crankshaft.

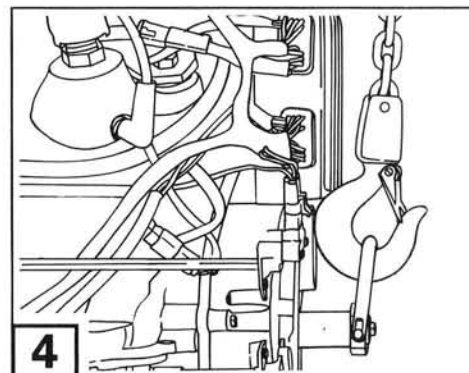

DRC6864



## Cable and Hose Information

**Important** Your boat must have the correct length control cables. The correct length is essential since the cables form the required 12 in. (30 cm) diameter loop in front of the engine.

For boat measuring procedure for determining cable length to outboard centerline, refer to the chart in **OMC Remote Control Instructions**. Use dimensions in Figure No. 1 to determine length from outboard centerline to engine connection (ie. 50 in. (127 cm) for control cables).

**2** Move control handle to FORWARD gear, idle speed, to retract both control cable guides. Hold the cables parallel to transom, measure the 50 in. (127 cm) distance from end of control cable guides, and mark location with tape.

Lay out cable and hose lengths. Leave the fuel line and speedometer hose separate from the electrical cables and hoses. The primer bulb must be accessible for priming and the fuel hose kept short to help prevent heat soak.

**1** Use the end of the control cable guides as a reference to measure the other cables and hoses. Notice that oil hoses **E** and **F** are 10 in. (26 cm) shorter than the control cables **G** and **H**, the battery cables **J** are 3 in. (8 cm) longer, and the hose and leads **K**, **L**, and **M** are 22 in. (183 cm) longer.

**3** Tape each item to the control cables at the required length for installation into flexweave sleeve. Lay out cables across stern and check for sleeve length. If necessary, cut sleeve with hot knife.

**4** Temporarily tape the remaining components to control cables. Loop bundle near the engine to check loop diameter and cable lengths. Arrange components so components are not tangled. Position control cables so they are at outside of loop and not restrained. Remove any extra tape from bundle.

**5** Slide sleeve over components and temporarily tape sleeve end to cables at bulkhead location. Slide the sleeve retaining ring **N** over the components.

Coil components toward starboard side of engine. Remove tape holding components to control cables.

**6** Remove screws retaining trunnion access cover and cable access cover. Remove covers.

