

## PREFACE

This manual covers the construction, function and servicing procedures of the Honda BF20A/BF25A outboard motors.

Careful observance of these instructions will result in better, safer service work.

Illustrations in this manual are based primarily on the BF25A LRS.

ALL INFORMATION, ILLUSTRATIONS, DIRECTIONS AND SPECIFICATIONS INCLUDED IN THIS PUBLICATION ARE BASED ON THE LATEST PRODUCT INFORMATION AVAILABLE AT THE TIME OF APPROVAL FOR PRINTING. HONDA MOTOR CO., LTD. RESERVES THE RIGHT TO MAKE CHANGES WITHOUT INCURRING ANY OBLIGATION WHATEVER. NO PART OF THIS PUBLICATION MAY BE REPRODUCED WITHOUT WRITTEN PERMISSION.

**HONDA MOTOR CO., LTD.**  
**SERVICE PUBLICATIONS OFFICE**

## CONTENTS

<b>SPECIFICATIONS</b>	<b>1</b>
<b>SERVICE INFORMATION</b>	<b>2</b>
<b>MAINTENANCE</b>	<b>3</b>
<b>ENGINE COVER/THROTTLE/CHOKE</b>	<b>4</b>
<b>FUEL SYSTEM</b>	<b>5</b>
<b>FLYWHEEL/TIMING BELT</b>	<b>6</b>
<b>RECOIL STARTER (TILLER HANDLE TYPE ONLY)</b>	<b>7</b>
<b>ENGINE REMOVAL/INSTALLATION</b>	<b>8</b>
<b>WATER JACKET COVER/THERMOSTAT/ THERMO SWITCH</b>	<b>9</b>
<b>CYLINDER HEAD/VALVES/OIL PUMP</b>	<b>10</b>
<b>CRANKCASE/CYLINDER BLOCK/ CRANKSHAFT/PISTON</b>	<b>11</b>
<b>PROPELLER/GEAR CASE/ EXTENSION CASE</b>	<b>12</b>
<b>OIL PAN/ENGINE UNDER CASE/ SWIVEL CASE</b>	<b>13</b>
<b>STEERING LINK ARM/REMOTE CONTROL BOX (REMOTE CONTROL TYPE ONLY)</b>	<b>14</b>
<b>THROTTLE CABLE RACKET/SHIFT LEVER/ TILLER HANDLE (TILLER HANDLE TYPE ONLY)</b>	<b>15</b>
<b>ELECTRICAL EQUIPMENT</b>	<b>16</b>
<b>OPERATION</b>	<b>17</b>
<b>WIRING DIAGRAM</b>	<b>18</b>
<b>BF30 SUPPLEMENT</b>	

# HONDA OUTBOARD MOTOR BF20A • BF25A

# SHOP MANUAL NEWS

Power Equipment

News No. P/P-032	Issue Date August '94
---------------------	--------------------------

## SOME PARTS OF CHANGES

Applicable information	Publication No.
BF20A • BF25A	66ZV700

## CHANGE LOCATIONS

The part numbers of the pin driver, 4mm and the special tool illustrations have been corrected as follows.

- Pin driver , 4mm

### BEFORE MODIFICATION

07944-9350200



### AFTER MODIFICATION

07744-0010300  
or 07944-SA00000

- Special tool illustrations

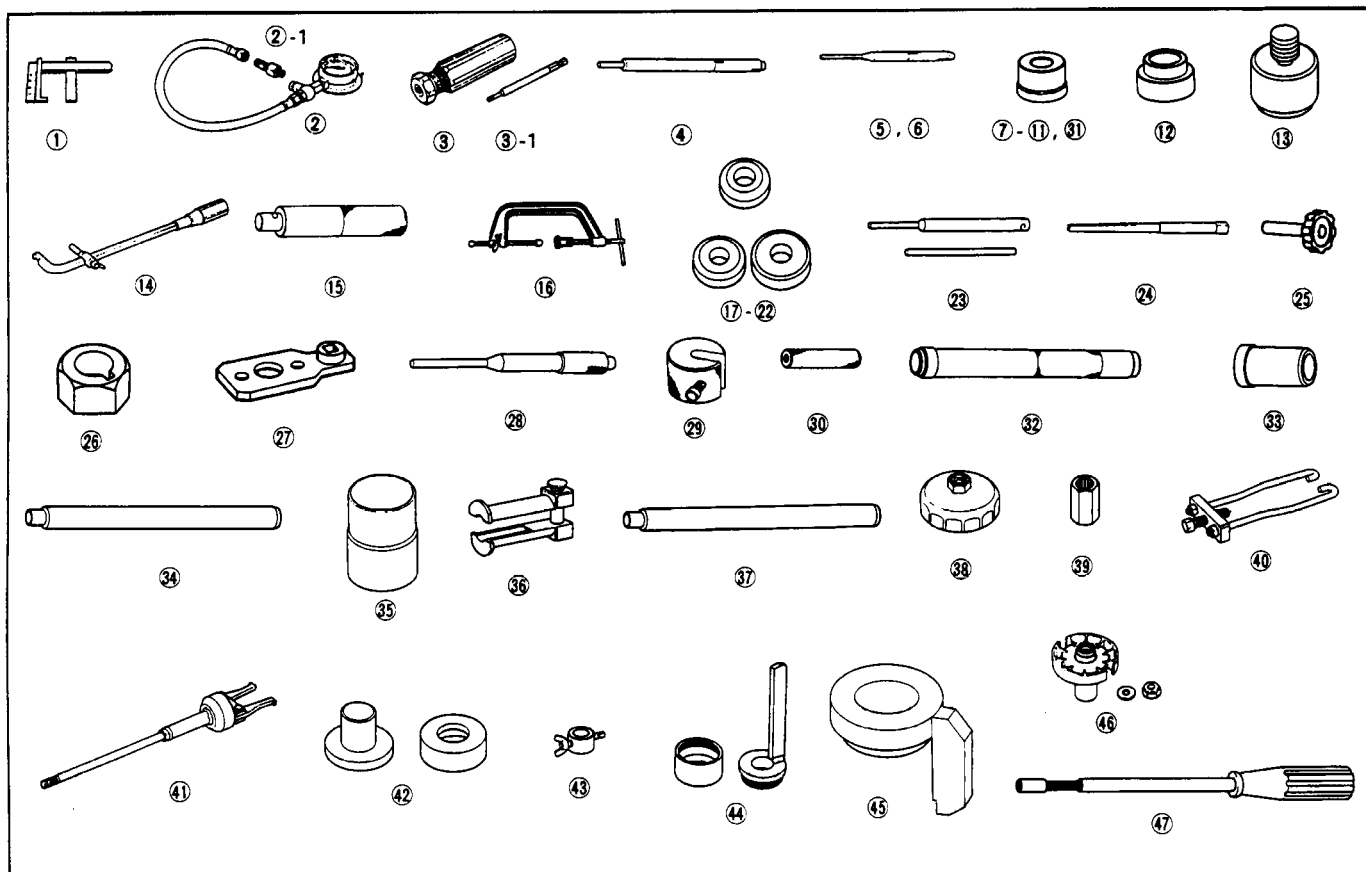

HONDA MOTOR CO., LTD.  
SERVICE PUBLICATIONS

1. SPECIFICATIONS	2. DIMENSIONAL DRAWINGS
-------------------	-------------------------

**1. SPECIFICATIONS**

**DIMENSIONS AND WEIGHTS**

Item	Model		BF20A					
	Description code		BAHS	BAHL	BAHS	BAHL	BAHS	BAHL
	Type		SH	LH	SHS	LHS	SRS	LRS
Overall length			*1: 675 mm (26.6 in) *2: 1,005 mm (39.6 in)				640 mm (25.2 in)	
Overall width			380 mm (15.0 in)				375 mm (14.8 in)	
Overall height			1,190 mm (46.9 in)	1,315 mm (51.8 in)	1,190 mm (46.9 in)	1,315 mm (51.8 in)	1,190 mm (46.9 in)	1,315 mm (51.8 in)
Dry weight			67 kg (147.7 lb)	69 kg (152.1 lb)	70 kg (154.3 lb)	72 kg (158.8 lb)	69 kg (152.1 lb)	71 kg (156.6 lb)
Operating weight (incl. oil)			69 kg (152.1 lb)	71 kg (156.6 lb)	72 kg (158.8 lb)	74 kg (163.2 lb)	71 kg (156.6 lb)	73 kg (161.0 lb)

\*1: With Tiller Handle raised

\*2: With Tiller Handle extended

**DIMENSIONS AND WEIGHTS**

Item	Model		BF25A					
	Description code		BAJS	BAJL	BAJS	BAJL	BAJS	BAJL
	Type		SH	LH	SHS	LHS	SRS	LRS
Overall length			*1: 675 mm (26.6 in) *2: 1,005 mm (39.6 in)				640 mm (25.2 in)	
Overall width			380 mm (15.0 in)				375 mm (14.8 in)	
Overall height			1,190 mm (46.9 in)	1,315 mm (51.8 in)	1,190 mm (46.9 in)	1,315 mm (51.8 in)	1,190 mm (46.9 in)	1,315 mm (51.8 in)
Dry weight			67 kg (147.7 lb)	69 kg (152.1 lb)	70 kg (154.3 lb)	72 kg (158.8 lb)	69 kg (152.1 lb)	71 kg (156.6 lb)
Operating weight (incl. oil)			69 kg (152.1 lb)	71 kg (156.6 lb)	72 kg (158.8 lb)	74 kg (163.2 lb)	71 kg (156.6 lb)	73 kg (161.0 lb)

\*1: With Tiller Handle raised

\*2: With Tiller Handle extended