

## PREFACE

This manual covers the construction, function and servicing procedures of the Honda BF20A/BF25A outboard motors.

Careful observance of these instructions will result in better, safer service work.

Illustrations in this manual are based primarily on the BF25A LRS.

ALL INFORMATION, ILLUSTRATIONS, DIRECTIONS AND SPECIFICATIONS INCLUDED IN THIS PUBLICATION ARE BASED ON THE LATEST PRODUCT INFORMATION AVAILABLE AT THE TIME OF APPROVAL FOR PRINTING. HONDA MOTOR CO., LTD. RESERVES THE RIGHT TO MAKE CHANGES WITHOUT INCURRING ANY OBLIGATION WHATEVER. NO PART OF THIS PUBLICATION MAY BE REPRODUCED WITHOUT WRITTEN PERMISSION.

**HONDA MOTOR CO., LTD.**  
**SERVICE PUBLICATIONS OFFICE**

## CONTENTS

<b>SPECIFICATIONS</b>	<b>1</b>
<b>SERVICE INFORMATION</b>	<b>2</b>
<b>MAINTENANCE</b>	<b>3</b>
<b>ENGINE COVER/THROTTLE/CHOKE</b>	<b>4</b>
<b>FUEL SYSTEM</b>	<b>5</b>
<b>FLYWHEEL/TIMING BELT</b>	<b>6</b>
<b>RECOIL STARTER (TILLER HANDLE TYPE ONLY)</b>	<b>7</b>
<b>ENGINE REMOVAL/INSTALLATION</b>	<b>8</b>
<b>WATER JACKET COVER/THERMOSTAT/ THERMO SWITCH</b>	<b>9</b>
<b>CYLINDER HEAD/VALVES/OIL PUMP</b>	<b>10</b>
<b>CRANKCASE/CYLINDER BLOCK/ CRANKSHAFT/PISTON</b>	<b>11</b>
<b>PROPELLER/GEAR CASE/ EXTENSION CASE</b>	<b>12</b>
<b>OIL PAN/ENGINE UNDER CASE/ SWIVEL CASE</b>	<b>13</b>
<b>STEERING LINK ARM/REMOTE CONTROL BOX (REMOTE CONTROL TYPE ONLY)</b>	<b>14</b>
<b>THROTTLE CABLE RACKET/SHIFT LEVER/ TILLER HANDLE (TILLER HANDLE TYPE ONLY)</b>	<b>15</b>
<b>ELECTRICAL EQUIPMENT</b>	<b>16</b>
<b>OPERATION</b>	<b>17</b>
<b>WIRING DIAGRAM</b>	<b>18</b>
<b>BF30 SUPPLEMENT</b>	

# SHOP MANUAL NEWS

PAGE 1 OF 2

**HONDA  
OUTBOARD MOTOR  
BF20A · BF25A**

**Power Equipment**

News No.  
P/P-035

Issue Date  
September '94

## SOME PARTS OF CHANGES

Applicable information	Publication No.
BF20A · BF25A	66ZV700

## CHANGE LOCATIONS

P.12-21

### 8. BACKLASH ADJUSTMENT

#### • FORWARD GEAR

##### BEFORE MODIFICATION

- 3) Turn the vertical shaft right and left while pressing it down with approximately 5 kg (11.0 lb) of force and measure the backlash.

Standard	0.10–0.29 mm (0.004–0.011 in)
----------	-------------------------------

- 4) If the backlash is too large, increase the forward gear shim thickness and recheck the backlash.  
If the backlash is too small, decrease the forward gear shim thickness and recheck the backlash.

P.12-22

#### • REVERSE GEAR

- 3) Turn the vertical shaft right and left while pressing it down with approximately 5 kg (11.0 lb) of force and measure the backlash.

Standard	0.10–0.39 mm (0.004–0.015 in)
----------	-------------------------------

- 4) If the backlash is too large, increase the reverse gear shim thickness and recheck the backlash.  
If the backlash is too small, decrease the reverse gear shim thickness and recheck the backlash.

##### AFTER MODIFICATION

- 3) Turn the vertical shaft right and left while pressing it down with approximately 5 kg (11.0 lb) of force and measure the backlash.

$$\text{Backlash} = \text{Dial Gauges measures} \times \frac{17.43^{*1}}{23^{*2}}$$

\*1 The pinion gear radius of pitch circle

\*2 The special tools (07MGJ-0010100) lever-length

Standard	0.10–0.29 mm (0.004–0.011 in)
----------	-------------------------------

- 4) If the backlash is too large, increase the forward gear shim thickness and recheck the backlash.  
If the backlash is too small, decrease the forward gear shim thickness and recheck the backlash.

Service limit	0.30 mm (0.012 in)
---------------	--------------------

- 3) Turn the vertical shaft right and left while pressing it down with approximately 5 kg (11.0 lb) of force and measure the backlash.

$$\text{Backlash} = \text{Dial Gauges measures} \times \frac{17.43}{23}$$

Standard	0.10–0.39 mm (0.004–0.015 in)
----------	-------------------------------

- 4) If the backlash is too large, increase the reverse gear shim thickness and recheck the backlash.  
If the backlash is too small, decrease the reverse gear shim thickness and recheck the backlash.

Service limit	0.40 mm (0.016 in)
---------------	--------------------

HONDA MOTOR CO., LTD.  
SERVICE PUBLICATIONS

# HONDA OUTBOARD MOTOR BF20A • BF25A

# SHOP MANUAL NEWS

Power Equipment

News No.  
P/P-032

Issue Date  
August '94

## SOME PARTS OF CHANGES

Applicable information	Publication No.
BF20A • BF25A	66ZV700

## CHANGE LOCATIONS

The part numbers of the pin driver, 4mm and the special tool illustrations have been corrected as follows.

- Pin driver , 4mm

### BEFORE MODIFICATION

07944-9350200



### AFTER MODIFICATION

07744-0010300  
or 07944-SA00000

- Special tool illustrations

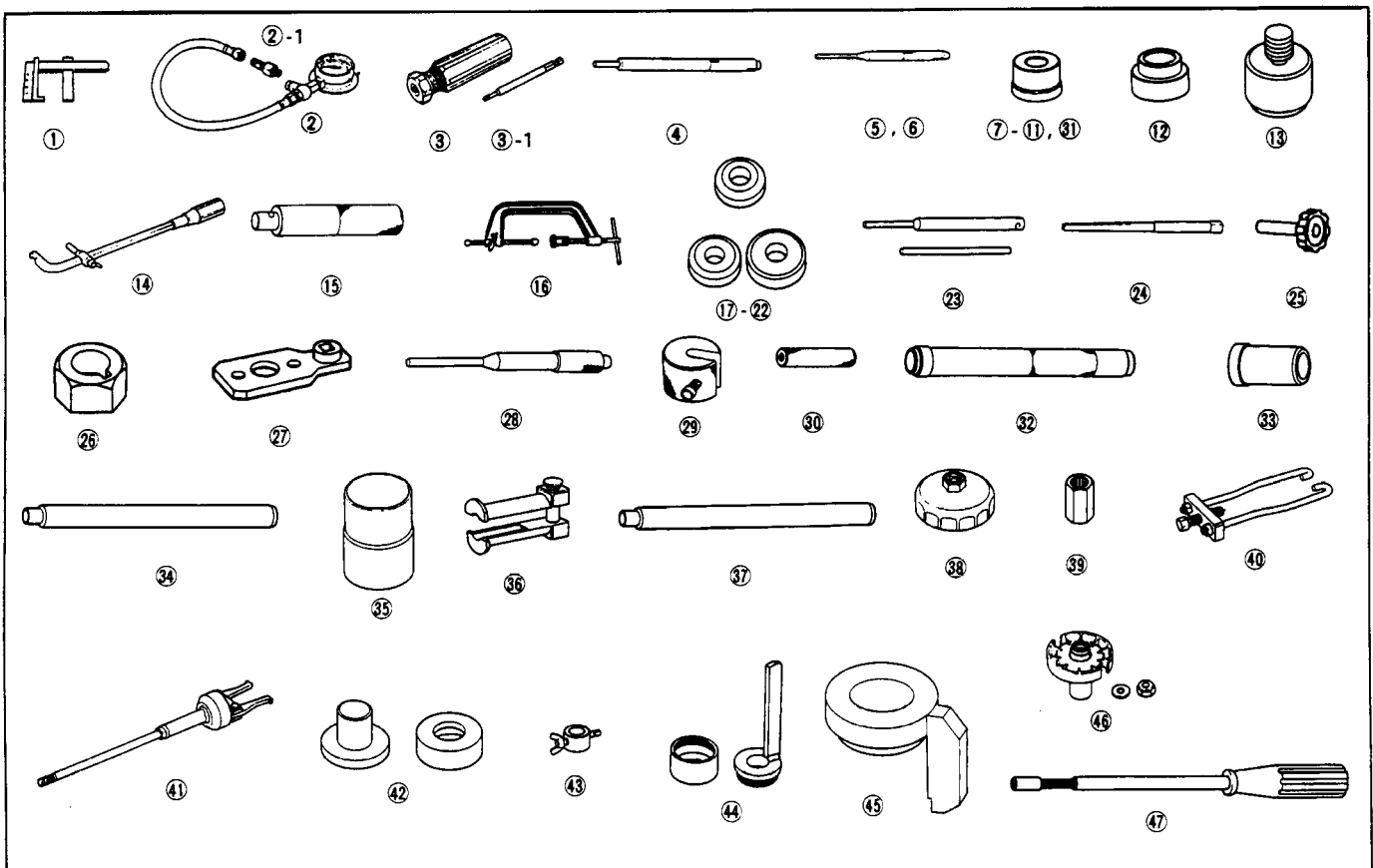

HONDA MOTOR CO., LTD.  
SERVICE PUBLICATIONS